

Series F Carbon Steel

Threaded End Connection

- Lever Operated Ball Valve
- To 5000 PSI WP
- 1" Through 4"
- Bolted Body Construction

- Multi-Seal Seats
- Bolted Body Protects Against End Adapter Blowout
- Fire Safe Design
- NACE Valves Include 316 Stainless Steel Ball and Stem
- Rugged Locking Device Standard
- Maintenance Free Sealing

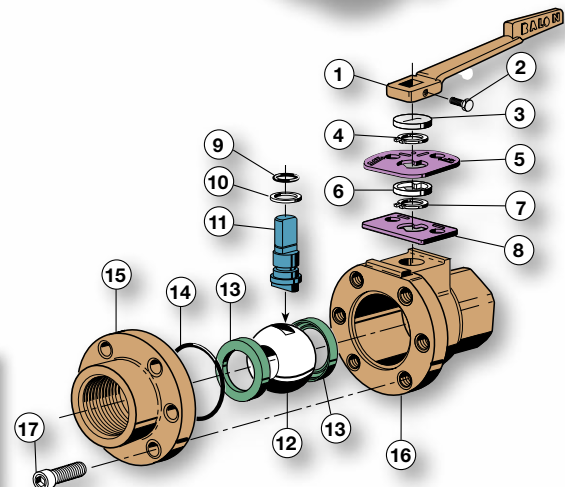

Material Description

ITEM	PART NAME	MATERIAL (STANDARD)	MATERIAL (NACE)
1	Handle*	Ductile Iron	Ductile Iron
2	Handle Bolt	Standard Hex Bolt	Standard Hex Bolt
3	Weather Guard	Polyethylene	Polyethylene
4	Lock Plate Retainer	Carbon Spring Steel	Carbon Spring Steel
5	Lock Plate	Carbon Steel	Carbon Steel
6	Dust Cover	Polyethylene	Polyethylene
7	Stop Plate Retainer	Carbon Spring Steel	Carbon Spring Steel
8	Stop Plate	Carbon Steel	Carbon Steel
9	Stem O-Ring	Buna-N	Fluorocarbon
10	Stem Seal	TFE	TFE
11	Stem	Carbon Steel	316 Stainless Steel
12	Ball	Carbon Steel Nickel Chrome Plated	316 Stainless Steel
13	Ball Seat	Nylon/Acetal (TFE Optional)	Nylon/Acetal (TFE Optional)
14	Body O-Ring	Buna-N	Fluorocarbon
15	End Adapter	ASTM A105	ASTM A105
16	Body	ASTM A105	ASTM A105
17	Body Bolts	ASTM A193 B7M	ASTM A193 B7M

* Balon valves are designed to be operated with a standard open-end wrench. Handle is optional.

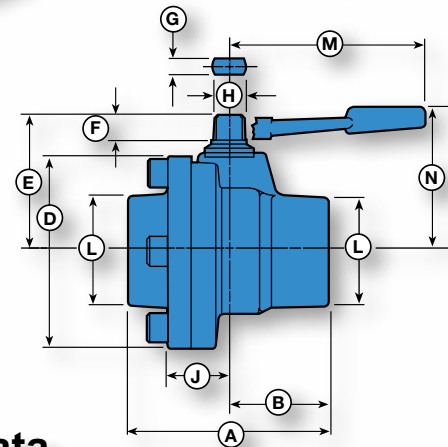

Dimensional Data

SIZE	CATALOG NUMBER		PORT	WP	A	B	D	E	F	G	H	J	L	M	N	LBS.	HANDLE	Cv
	STANDARD TRIM CARBON STEEL BALL & STEM	NACE TRIM 316 SS BALL & STEM																
1x1x1	1F-F93-SE	1F-F93N-SE	1	2500	3.87	1.93	3.37	2.37	.50	.340	.685	1.12	1.87	4.37	2	4.3	P-333-CS	-
1x1x1	1F-F03-SE	1F-F03N-SE	1	3000	3.87	1.93	3.37	2.37	.50	.340	.685	1.12	1.87	4.37	2	4	P-333-CS	-
1.5x1.5x1.5	1.5F-F03-SE	1.5F-F03N-SE	1.5	3000	5.25	2.62	5.12	3.62	.75	.434	.873	1.62	2.50	7.25	5	12.8	P-4128-DI	-
2x1.5x2	2R-F93-SE	2R-F93N-SE	1.5	2500	5.50	2.75	5.12	3.62	.75	.434	.873	1.62	3	7.25	5	13.5	P-4128-DI	125
2x1.5x2	2R-F03-SE	2R-F03N-SE	1.5	3000	5.50	2.75	5.12	3.62	.75	.434	.873	1.62	3	7.25	5	13	P-4128-DI	125
2x1.5x2	2R-F5M-SE	2R-F5MN-SE	1.5	5000	6	3	6	3.62	.75	.434	.873	1.75	3.25	10.25	5.37	20	P-4125-DI	125
2x2x2	2F-F93-SE	2F-F93N-SE	2	2000	5.75	2.87	6.12	4.37	.87	.497	.998	2	3.12	10.25	5.37	20	P-4129-DI	-
2x2x2	2F-F03-SE	2F-F03N-SE	2	2500	5.75	2.87	6.12	4.37	.87	.497	.998	2	3.12	10.25	5.37	20	P-4129-DI	-
3x2x3	3R-F93-SE	3R-F93N-SE	2	2000	7.62	3.81	6.87	4.37	.87	.497	.998	2.06	4.25	10.25	5.37	32	P-4129-DI	180
3x3x3	3F-F63-SE	3F-F63N-SE	3	1500	8.37	4.18	8	5.75	1.06	.747	1.373	2.50	4.25	20	6.75	46	P-4127-DI	-
4x3x4	4R-F63-SE	4R-F63N-SE	3	1500	8.87	4.43	8	5.75	1.06	.747	1.375	2.43	5.25	20	6.75	47	P-4127-DI	500

BALON.

3245 S. Hattie • Oklahoma City, Oklahoma 73129 • Telephone: (405) 677-3321 • Fax: (405) 677-3917
e-mail: balon@balon.com • www.balon.com