



# GATE VALVES- BOLTED BONNET- FULL PORT

BONNEY FORGE

**1500 LB.**

**2500 LB.**

**Design construction:**

- ASME B16.34 - BS 5352
- Outside Screw and Yoke (OS&Y)
- Self aligning two piece packing gland
- Integral backseat
- Oval ring joint gasket
- Socket Weld Ends to ASME B16.11
- Screwed Ends (NPT) to ASME B1.20.1
- Butt Welding Ends to ASME B16.25

Ratings standard class:

- carbon steel class 1500 3705 psig @ 100°F  
255 bar + 38°C
- carbon steel class 2500 6170 psig @ 100°F  
425 bar + 38°C

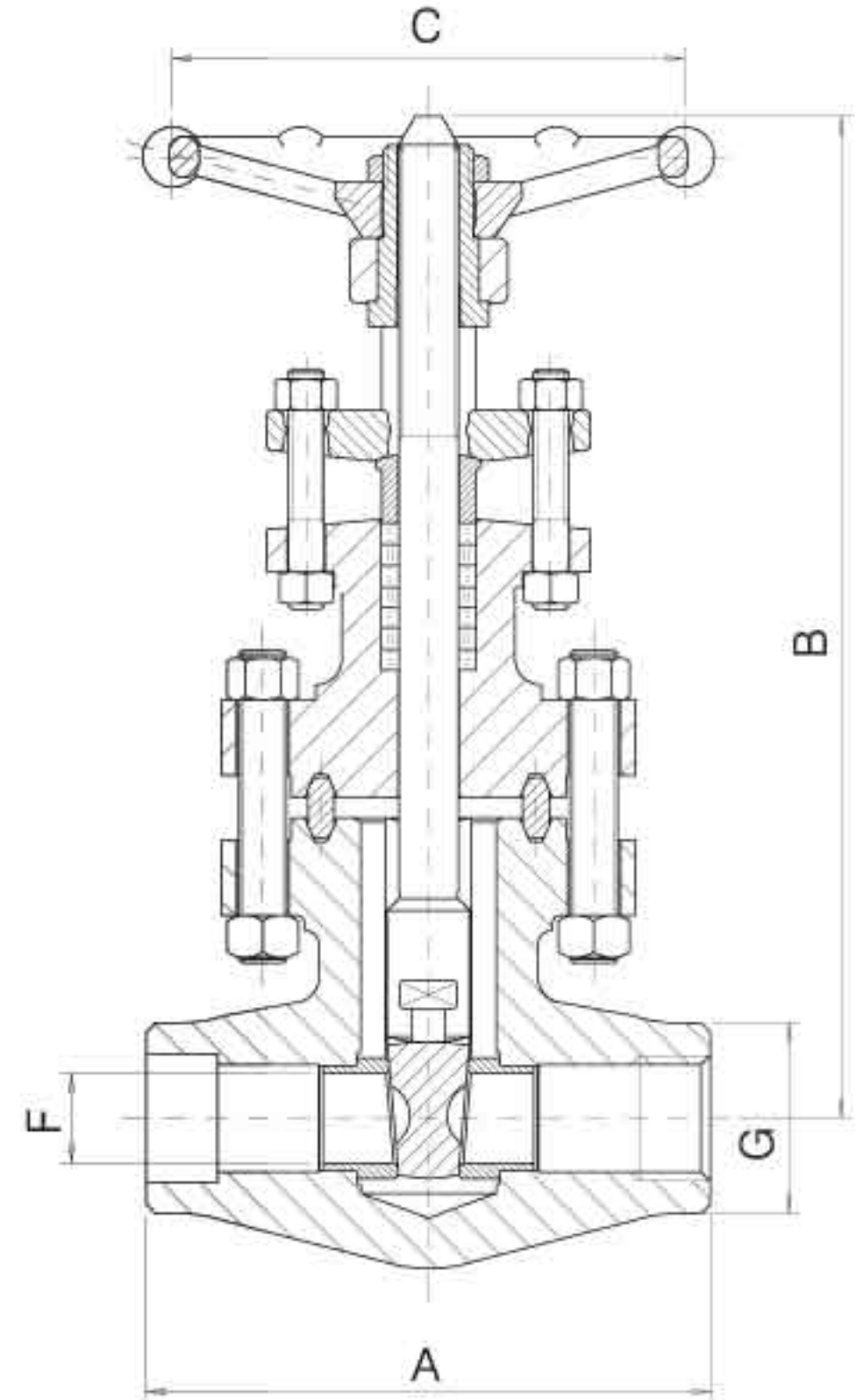

		FULL PORT – FIG. H9R 10						
SIZE	inch mm	1/2 15	3/4 20	1 25	1 1/4 32	1 1/2 40	2 50	
1500 LB.	A	inch mm	4.33 110	5.91 150	5.91 150	8.27 210	8.27 210	9.06 230
	B open	inch mm	9.17 233	11.38 289	11.54 293	14.06 357	14.41 366	17.76 451
	C	inch mm	5.43 138	5.43 138	5.43 138	6.77 172	6.77 172	9.21 234
	F	inch mm	.55 14	.71 18	.94 24	1.16 29.5	1.44 36.6	1.89 48
	G	inch mm	1.5 38	2.17 55	2.17 55	2.95 75	2.95 75	3.62 92
	Weight	lb. kg	11 5	20.25 9.2	20.25 9.2	44 20	44 20	79.25 36
	PACKING		2B3	2B4	2B4	2B5	2B5	9B8
	GASKET		R12	R17	R17	R20	R20	R24

		FULL PORT – FIG. 25HR 10						
SIZE	inch mm	1/2 15	3/4 20	1 25	1 1/2 40	2 50		
2500 LB.	A	inch mm	5.91 150	5.91 150	8.27 210	9.06 230	9.06 230	
	B open	inch mm	11.10 282	11.3 287	13.70 348	15.98 406	17.20 437	
	C	inch mm	5.43 138	5.43 138	6.77 172	9.21 234	9.21 234	
	F	inch mm	.45 11.5	.59 15	.77 19.5	1.10 28	1.38 35	
	G	inch mm	2.17 55	2.17 55	2.95 75	3.62 92	3.62 92	
	Weight	lb. kg	22 10	22 10	48.5 22	81.5 37	79.25 36	
	PACKING		2B4	BH8	BH8	9B8	25B8	
	GASKET		R16	R16	R17	R20	R22	