

# Wm. E. Williams No. 302F2 Class 300 RF Globe Valve ASTM A 216 WCB (API Trim 8)

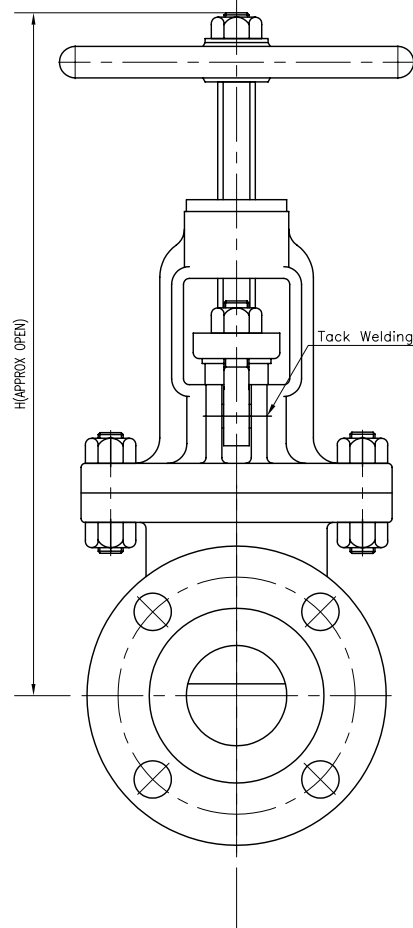
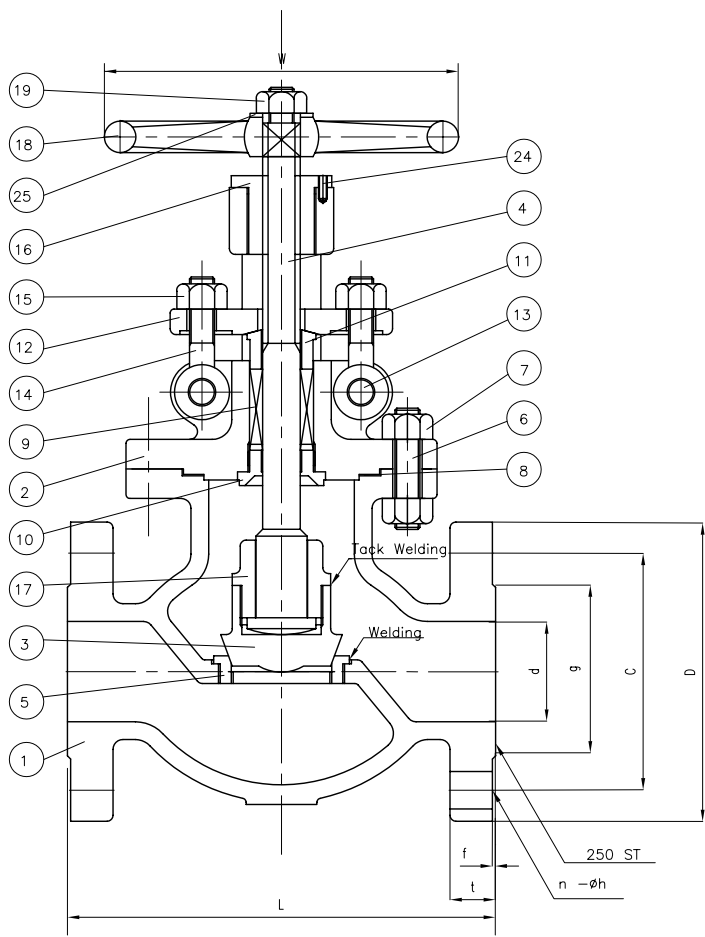

| BILL OF MATERIALS |              |                  |                         |   |
|-------------------|--------------|------------------|-------------------------|---|
| NO.               | PART NAME    | MATERIALS        | Q'TY                    |   |
| 1                 | BODY         | A216Gr WCB       | 1                       |   |
| 2                 | BONNET       | A216Gr WCB       | 1                       |   |
| 3                 | DISC         | 6" & BELOW       | A217Gr CA15             | 1 |
|                   |              | 8" & OVER        | A216Gr WCB W/13Cr FACED |   |
| 4                 | STEM         | A479Gr 410       | 1                       |   |
| 5                 | SEAT RING    | A105 H/F-CO-Cr A | 1                       |   |
| 6                 | BONNET BOLT  | A193Gr B7        | 1SET                    |   |
| 7                 | BONNET NUT   | A194Gr 2H        | 1SET                    |   |
| 8                 | GASKET       | P#1400G          | 1                       |   |
| 9                 | PACKING      | P#6610+P#6528    | 1SET                    |   |
| 10                | BACK SEAT    | A479Gr 410       | 1                       |   |
| 11                | GLAND RING   | A479Gr 410       | 1                       |   |
| 12                | GLAND FLANGE | A105 or WCB      | 1                       |   |
| 13                | HINGE PIN    | A105 or 410      | 2                       |   |
| 14                | GLAND BOLT   | A307Gr B         | 2                       |   |
| 15                | GLAND NUT    | A307Gr B         | 2                       |   |
| 16                | BONNET BUSH  | A439Gr D2C       | 1                       |   |
| 17                | DISC NUT     | A217Gr CA15      | 1                       |   |
| 18                | HAND WHEEL   | A197             | 1                       |   |
| 19                | HANDLE NUT   | A307Gr B         | 1                       |   |
| 24                | SET SCREW    | STEEL            | 1                       |   |
| 25                | WASHER       | STEEL            | 1                       |   |

UNIT: INCH

| SIZE  | d     | L     | D     | C     | g     | t    | f     | n-h     | H     | W     |
|-------|-------|-------|-------|-------|-------|------|-------|---------|-------|-------|
| 2.00  | 2.00  | 10.50 | 6.50  | 5.00  | 3.62  | 0.88 | 0.060 | 8-0.75  | 14.75 | 7.12  |
| 2.50  | 2.50  | 11.50 | 7.50  | 5.87  | 4.12  | 1.00 | 0.060 | 8-0.87  | 15.35 | 7.87  |
| 3.00  | 3.00  | 12.50 | 8.25  | 6.63  | 5.00  | 1.12 | 0.060 | 8-0.87  | 18.87 | 8.81  |
| 4.00  | 4.00  | 14.00 | 10.00 | 7.87  | 6.19  | 1.25 | 0.060 | 8-0.87  | 22.00 | 10.25 |
| 5.00  | 5.00  | 15.75 | 11.00 | 9.25  | 7.31  | 1.38 | 0.060 | 8-0.87  | 24.21 | 12.43 |
| 6.00  | 6.00  | 17.50 | 12.50 | 10.63 | 8.50  | 1.44 | 0.060 | 12-0.87 | 26.41 | 13.97 |
| 8.00  | 8.00  | 22.00 | 15.00 | 13.00 | 10.62 | 1.62 | 0.060 | 12-1.00 | 30.94 | 15.75 |
| 10.00 | 10.00 | 24.50 | 17.50 | 15.25 | 12.75 | 1.88 | 0.060 | 16-1.12 | 35.90 | 17.71 |
| 12.00 | 12.00 | 28.00 | 20.50 | 17.75 | 15.00 | 2.00 | 0.060 | 16-1.25 | 42.95 | 17.71 |

| △   |      |                     |       |       |       |
|-----|------|---------------------|-------|-------|-------|
| △   |      | CORRECT "L" DIM     |       |       |       |
| △   |      | ISSUED FOR PROPOSAL |       |       |       |
| NO. | DATE | DESCRIPTION         | PRP'D | REV'D | APP'D |



|                |                      |                            |       |         |  |
|----------------|----------------------|----------------------------|-------|---------|--|
| MARKING SYSTEM | MSS-SP-25            | INSPECTION & TEST: API 598 |       |         |  |
| DIM. OF FLANGE | ANSI B16.5           | SHELL                      | HYDRO | 1125PSI |  |
| FACE TO FACE   | ANSI B16.10          | SEAT                       | AIR   | 80PSI   |  |
| WALL THICKNESS | API 600              | BACK SEAT                  | HYDRO | 825PSI  |  |
| DESIGNED       | API 600, ANSI B16.34 |                            |       |         |  |

|       |       |  |      |  |
|-------|-------|--|------|--|
| TITLE |       | CAST STEEL GLOBE VALVE<br>CLASS 300 B,B R,F OS&Y |      |  |
| SCALE | Fig # | DRAWING NO.                                      | REV. |  |
| NONE  | 302F2 | 60GL060142                                       | 01   |  |

# Wm. E. Williams No. 302W2 Class 300 BW Globe Valve ASTM A 216 WCB (API Trim 8)

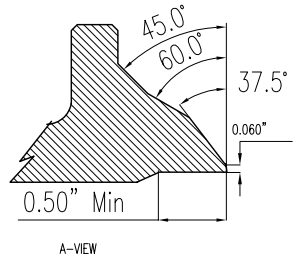
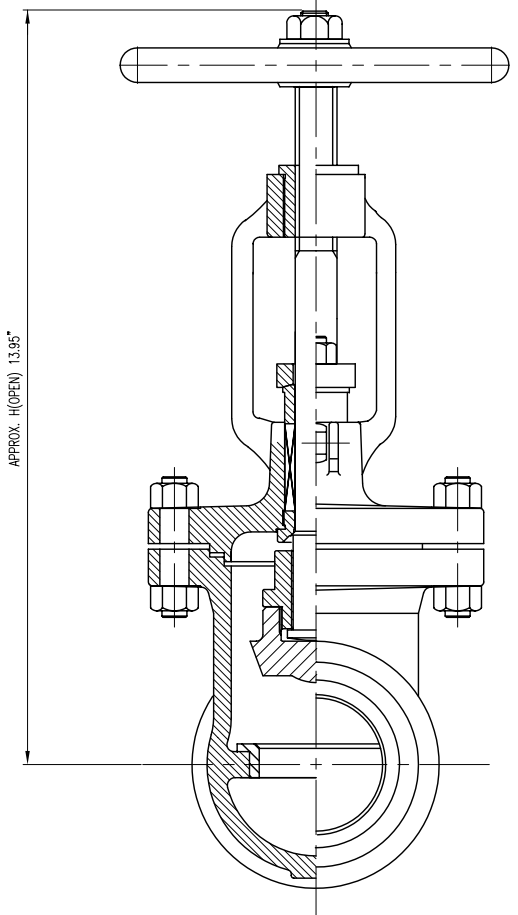
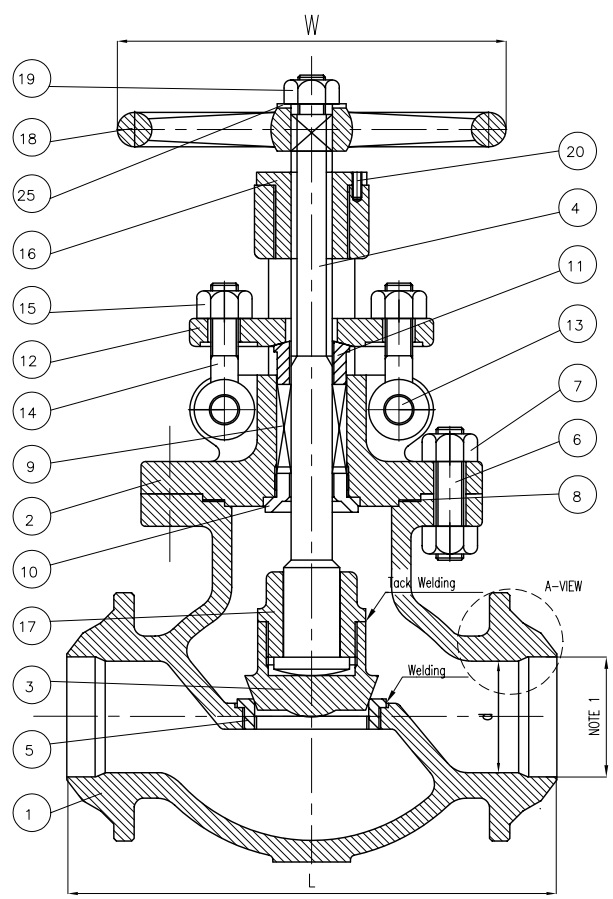

UNIT: INCH

| SIZE  | d     | L     | H     | W     |
|-------|-------|-------|-------|-------|
| 2.0   | 2.00  | 10.50 | 14.75 | 7.12  |
| 2.5   | 2.50  | 11.50 | 15.35 | 7.87  |
| 3.0   | 3.00  | 12.50 | 18.87 | 8.81  |
| 4.0   | 4.00  | 14.00 | 22.00 | 10.25 |
| 6.0   | 6.00  | 17.50 | 26.41 | 13.97 |
| 8.0   | 8.00  | 22.00 | 30.94 | 15.75 |
| 10.00 | 10.00 | 24.50 | 35.90 | 17.71 |
| 12.00 | 12.00 | 28.00 | 42.95 | 17.71 |

\* Other sizes available upon request.

| BILL OF MATERIALS |              |                  |                         |   |
|-------------------|--------------|------------------|-------------------------|---|
| NO.               | PART NAME    | MATERIALS        | Q'TY                    |   |
| 1                 | BODY         | A216Gr WCB       | 1                       |   |
| 2                 | BONNET       | A216Gr WCB       | 1                       |   |
| 3                 | DISC         | 6" & BELOW       | A217Gr CA15             | 1 |
|                   |              | 8" & OVER        | A216Gr WCB W/13Cr FACED |   |
| 4                 | STEM         | A479Gr 410       | 1                       |   |
| 5                 | SEAT RING    | A105 H/F C0-Cr A | 1                       |   |
| 6                 | BONNET BOLT  | A193Gr B7        | 1SET                    |   |
| 7                 | BONNET NUT   | A194Gr 2H        | 1SET                    |   |
| 8                 | GASKET       | P#1400G          | 1                       |   |
| 9                 | PACKING      | P#6610+P#6528    | 1SET                    |   |
| 10                | BACK SEAT    | A479Gr 410       | 1                       |   |
| 11                | GLAND RING   | A479Gr 410       | 1                       |   |
| 12                | GLAND FLANGE | A105 or WCB      | 1                       |   |
| 13                | HINGE PIN    | A105 or 410      | 2                       |   |
| 14                | GLAND BOLT   | A307Gr B         | 2                       |   |
| 15                | GLAND NUT    | A307Gr B         | 2                       |   |
| 16                | BONNET BUSH  | A439Gr D2C       | 1                       |   |
| 17                | DISC NUT     | A217Gr CA15      | 1                       |   |
| 18                | HAND WHEEL   | A197             | 1                       |   |
| 19                | HANDLE NUT   | A307Gr B         | 1                       |   |
| 24                | SET SCREW    | STEEL            | 1                       |   |
| 25                | WASHER       | STEEL            | 1                       |   |

NOTE:  
 1. SPECIFY THE PIPE SCHEDULE No. REQUIRED.  
 2. OTHER TRIMS AVAILABLE.

|  |       |             |       |           |       |
|--|-------|-------------|-------|-----------|-------|
| ISSUED FOR PROPOSAL                                  |       |             |       |           |       |
| NO.  | DATE  | DESCRIPTION | PRP'D | REV'D     | APP'D |
|  |       |             |       |           |       |
| TITLE  |       |             |       |           |       |
| CAST STEEL GLOBE VALVE<br>CLASS 300 B,B BUTTWELD END |       |             |       |           |       |
| SCALE  | FIG#  | DRAWING NO. |       | REV.<br>0 |       |
| NONE   | 302W2 | 60GL060143  |       |           |       |

|                |                      |                            |       |           |  |
|----------------|----------------------|----------------------------|-------|-----------|--|
| MARKING SYSTEM | MSS-SP-25            | INSPECTION & TEST: API 598 |       |           |  |
| BUTT WELDING   | ANSI B16.25          | SHELL                      | HYDRO | 1125 PSIG |  |
| FACE TO FACE   | ANSI B16.10          | SEAT                       | AIR   | 80 PSIG   |  |
| WALL THICKNESS | ANSI B16.34          | BACK SEAT                  | HYDRO | 815 PSIG  |  |
| OVERALL        | API 600, ANSI B16.34 |                            |       |           |  |